

NOTE:
 Refer to CSEA Consulting Engineers drawings for topographical survey, proposed levels, retaining structures, traffic lighting and drainage details.
 Refer to Gannon + Associates drawings for Landscape Layout and details.

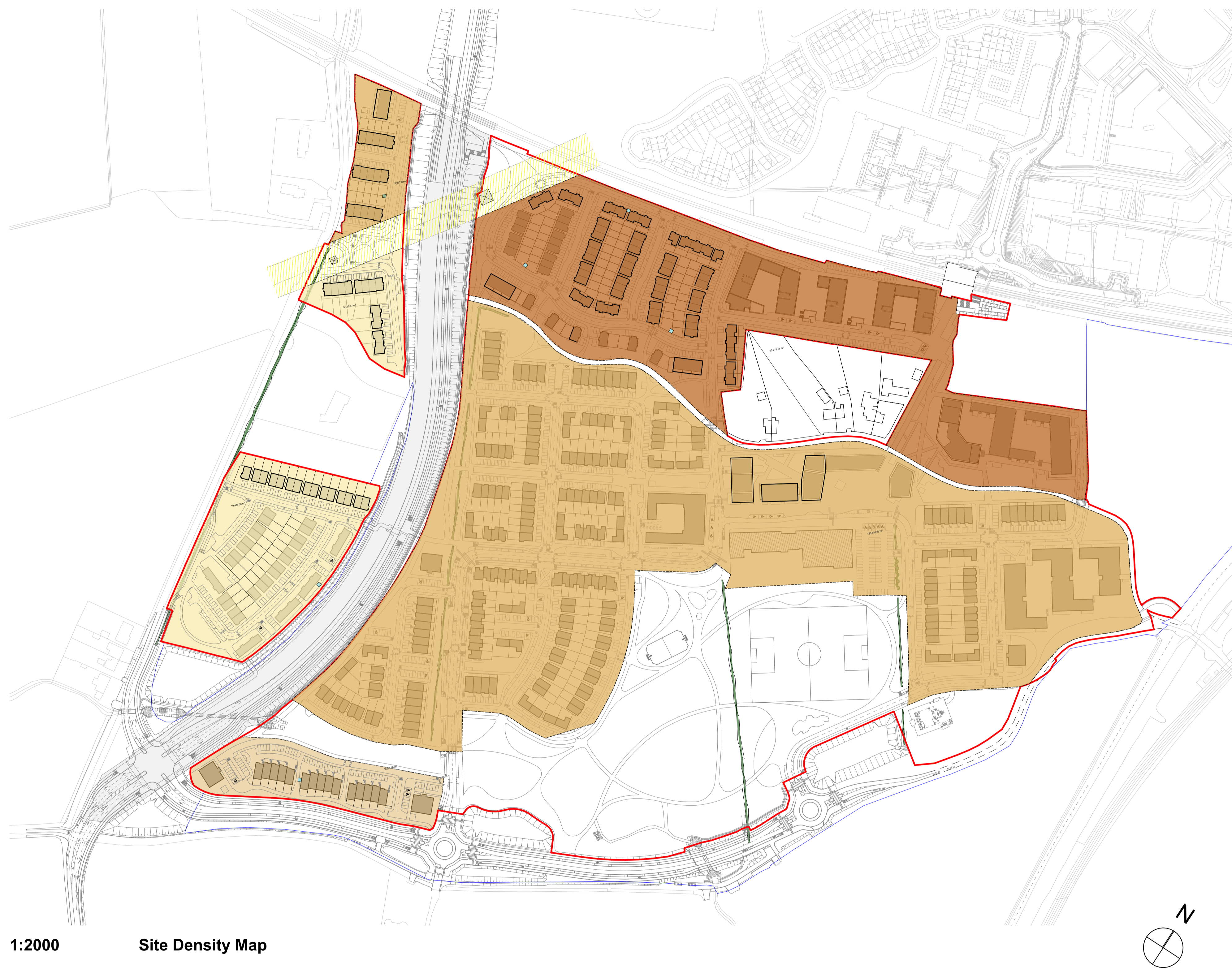

1:2000 Site Density Map

- High density** development area: 5.5 Hectares – comprises
 - Railway Quarter [211 Units]
 - Link Road East [91 Units]
 - Station Plaza [166 Units]
 Total Units = 468 / Density 85 Per Hectare

- Medium density** development area: 13.8 Hectares – comprises
 - Barnhill Stream [98]
 - Barnhill Cross [195]
 - Village Centre [118]
 - Station Quarter South [201]
 - Barnhill Crescent [77]
 - Part of Link Road West [21]
 Total Units = 710 / Density 51 Per Hectare

- Low density** development area: 2.4 Hectares – comprises
 - Part of Link Road West [12]
 - Parkside [53]
 Total Units = 65 / Density 27 Per Hectare

RIAI	Planning Application	DELPHI ARCHITECTURE + PLANNING
DAVEY + SMITH ARCHITECTS Unit 13, THE SEAPORT BUILDING, 44-45 CLONTARF ROAD, CLONTARF, DUBLIN 3 PH: 01 2477638 EMAIL: info@devay-smith.com WEB: www.devay-smith.com		
Layout ID: PLA-17 Project: Barnhill Residential Development Drawing Name: Site Density Map	Scale: 1:2000 Job No: <Project info> Series: Planning Date: 15/07/2022 Status:	
THIS DRAWING TO BE READ IN CONJUNCTION WITH RELEVANT CONSULTANTS DRAWINGS - NOTIFY ARCHITECTS OF ANY DISCREPANCIES - CHECK DIMENSIONS ON SITE - USE FIGURE DIMENSIONS ONLY - COPYRIGHT RESERVED FOR DAVEY + SMITH ARCHITECTS LTD.		